



MURPHY BEDS & CUSTOM CABINETS

Factory Direct To Your Home



www.usamurphybeds.com

1-866-986-2337

MURPHY BEDS

General Features

1. Patented Hinge Mechanism.

- ✓ No need to secure through floor so bed can be relocated at a later date without a large mess to clear up.
- ✓ 19.5" cabinet depth with built in box spring giving a good mattress height.
- ✓ Accommodates standard mattresses up to 12" thick.
- ✓ Adjustable tension springs ensuring lightweight operation & total safety with no possibility of hydraulic leakage.
- ✓ Lifetime year warranty on patented mechanism.

2. Quality Cabinet Construction

- ✓ 20 years experience producing durable products.
- ✓ Quality plywood construction.
- ✓ NO CHEAP PARTICLE BOARD, FIBERBOARD, PRESSED WOOD OR MELAMINE.
- ✓ Solid Maple or Oak doors & panels on raised panel models.

3. Extensive Choice of Finish

- ✓ Choice of standard wood colors, unfinished or color matched to existing furniture.
- ✓ Full range of matching cabinetry and desk tops available to complete the room.
- ✓ Twin, full, queen & king sizes available.

4. Value For Money

- ✓ Good service, quality and attention to detail.
- ✓ Free factory design service.
- ✓ Factory direct delivery.

Standard Murphy Bed Models

Traditional Raised Panel (TRP)

The TRP Murphy Bed range is manufactured from the best quality materials with all cabinetry constructed of 3/4" thick maple plywood and all faces, doors, moldings and drawers being machined from solid maple.



Framed Flat Panel (FFP)

The FFP Murphy Bed range is manufactured from the best quality materials with all cabinetry of 3/4" thick maple plywood. All faces, doors and drawers are of maple plywood framed with solid maple wood.

Table Model (FT)

The FT Murphy Bed range is manufactured from the best quality 3/4" birch and maple plywood. The bed has a foldaway table in the face to make the most use of space in home offices, craft rooms, efficiencies, studies and dorms. The FT bed has 3 positions: bed down, table down & both bed and table up for maximum versatility. The table is over 40" x 30" to provide a large working area.



Plain Panel (PP)

The PP Murphy Bed range is manufactured from the best quality 3/4" thick birch & maple plywood with no cheap particleboard, fiberboard or melamine.

Horizontal (HZ)

The Horizontal Murphy Bed (sometimes referred to as a 'side mount') is ideal for applications where the room layout does not allow for a standard vertical Murphy bed. The HZ Murphy Bed range is manufactured from the best quality 3/4" thick birch & maple plywood and a steel frame.



Colors

The standard colors below apply to all USA Murphy Beds & Cabinetry.

If none of these are suitable for your application, USA Murphy Beds will match any color to your other furniture at a fixed upgrade cost of \$85.

Alternatively, all murphy beds and cabinets can be supplied in unfinished wood for you to stain or paint at a discount of 20% off the pricelist. Please specify 'unfinished' for this option.



Sizes

For TRP, FFP, FT and PP.

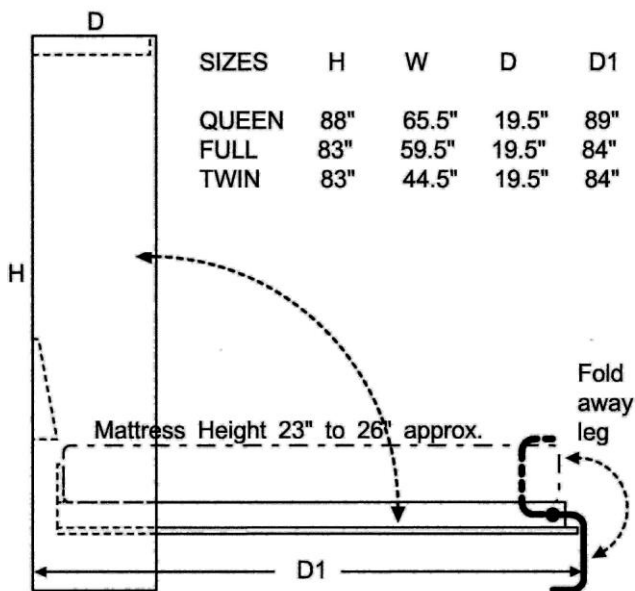

For a king size Murphy bed, available in the FFP range, the sizes are as the queen beds except that W is 81.5"

For Horizontal beds

	W	H	D	D1
TWIN	81.5"	47.5"	16"	48"
FULL	81.5"	62.5"	16"	63"
QUEEN	86.5"	68.5"	16"	69"

STANDARD COMPANION CABINETS FOR MURPHY BEDS

FULL SIZE CABINETS

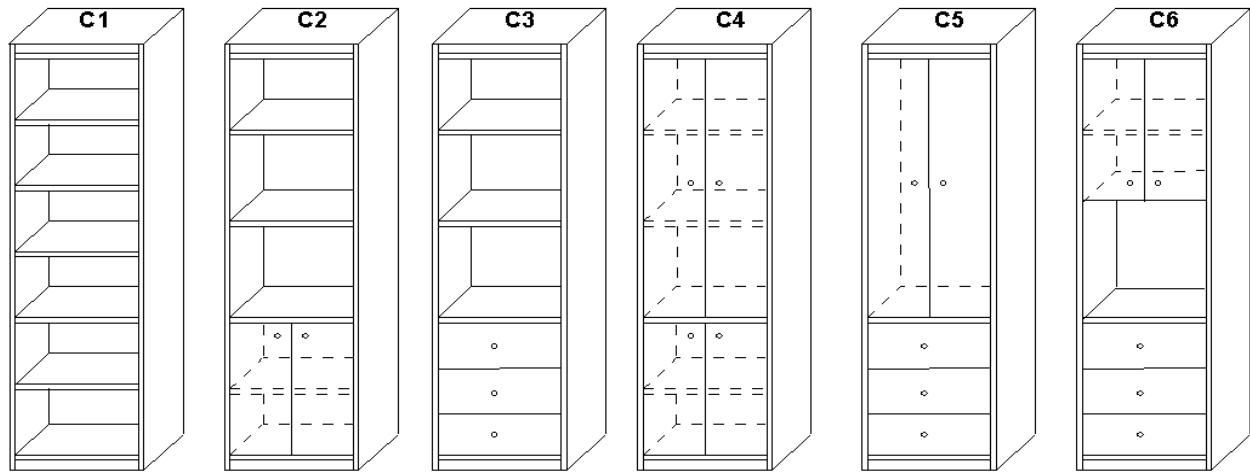

For full cabinets ordered individually the height is the same as the murphy bed.
width is 24" standard and depth is 19.5" standard.

For staggered cabinets shorter than the murphy bed see 'Murphy Bed Combo Deals'

BASE CABINETS

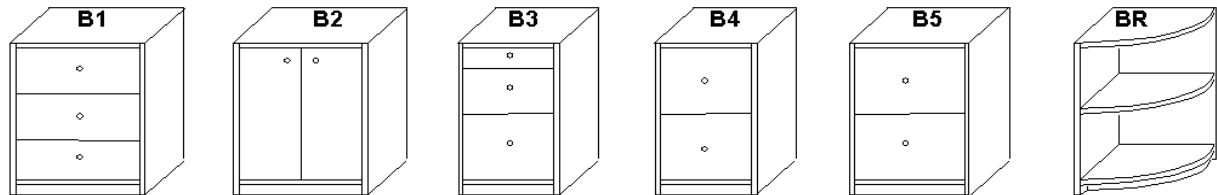

Regular drawer
stack. 24" wide

Regular cabinet
24" wide

Office drawer
stack 16.5" wide

File drawer stack
(letter) 16.5" wide

File drawer stack
(legal) 21" wide

Radius base
shelf unit

Base cabinets 28.5" high and 18" deep designed to fit under desk top
To use any base cabinets as nightstands beside murphy bed, add nightstand top

WALL CABINETS

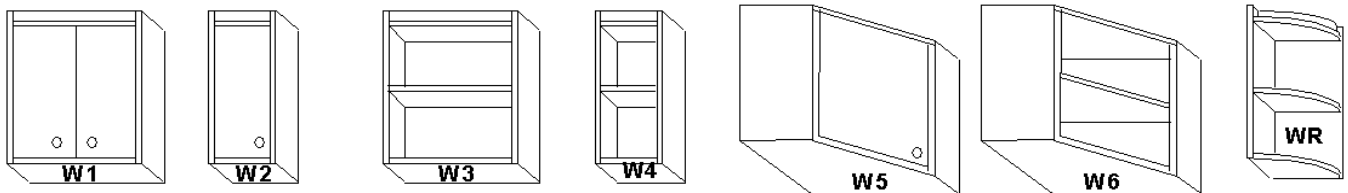

Double cabinet
with single
shelf. 24" wide

Single cabinet
with shelf.
12" wide

Double shelf
unit, 24" wide

Single shelf
unit, 12" wide

Corner cabinet with
1 shelf. 24" x 24"

Corner shelf unit.
24" x 24"

Radius wall
shelf unit

Wall cabinets are 30" high and 12" deep as standard